

LOS ANGELES COUNTY
DEPARTMENT OF PUBLIC WORKS

BENCH MARK LIST



WATTS QUAD

1994 ADJUSTMENT

PREFACE

The Department of Public Works level net is composed of more than 1,700 miles of levels supporting in excess of 9,000 bench marks. Previously when a major readjustment of the net was undertaken, to emphasize the complete break with previous elevations, the CY, CG, & CL, series bench marks were re-labeled DY, DG, & DL, respectively.

Beginning in 1993 the baseline readjustment year will be indicated on baseline BM,s only indicated below (*). Henceforth all BM numbers will be labeled as a Y, G, or L, series that will no longer indicate the major adjustment year.

To facilitate the adjustment, indexing and distribution of adjusted values of the net, the county territory was divided into 33 quads or areas. For the identification purposes each quad was given a name, viz., "Rosemead," "La Mirada," "Santa Fe," etc. When bench marks and elevations in these quads are used, the name must be included in the bench mark description, e.g.,

* BASELINE 295.461 L&BR IN CTR OF CB RET @ NE COR Y 9191
(1990) LA HABRA BLVD & VALLEY HOME AVE
35FT N & 35FT E/O C/L INT

It is expected that this general adjustment will for the most part remain sound for 8 to 12 years. Updating constrained adjustments will continue in the future. When a quad is readjusted, new elevations will be published and the date of readjustment will be noted in the bench mark description. Two bench marks with different adjustment dates will not normally agree with each other.

The basic accuracy of the net is reflected by an indicated field probable error of plus or minus 0.012 foot per mile of leveling as determined from the conditions of closure. However, many years of experience in vertical control in the greater Los Angeles basin and Antelope Valley indicate that because of varying degrees of subsidence and heaving, the true datum is recovered only by obtaining substantial agreement of a number of bench marks.

The users of this net are invited to assist in its maintenance by notifying this department of cases of obliteration, apparent mistakes in description or elevations, and proven disturbance of bench marks.

=====

DATUM: U.S. Coast and Geodetic Survey Sea Level Datum
of 1929, through the medium of the Los Angeles
County Engineer Precise Level Net.

ABBREVIATIONS USED IN BENCH MARK LISTINGS

ABUT -----	Abutment	ECR -----	End of Curb Return
ALG -----	Along	EC -----	End of Curve
ANG PT -----	Angle Point	ENT -----	Entrance
B/W -----	Back of Walk	FL -----	Floor
BCR -----	Beginning of Curb Return	FTG -----	Footing
BC -----	Beginning of Curve	FRWY -----	Freeway
BLDG -----	Building	F/W -----	Front of Walk
BM -----	Bench Mark	GAR -----	Garage
BT SPK -----	Boat or Bolt Spike	HDWL -----	Headwall
BR CAP -----	Brass or Bronze Cap	HSE -----	House
C B -----	Catch Basin	HWY -----	Highway
CTR -----	Center	INT -----	Intersection
C/L -----	Center Line	IP -----	Iron Pipe
C/L INT -----	Center Line Intersection	LT -----	Left
C/L PROD -----	Center Line Produced	LACE -----	L.A. City Engineer
CONC -----	Concrete	LACS -----	L.A. Co. Engineer
COR -----	Corner	LAFC -----	L.A. Co. Flood Control
COE -----	Corps of Engineers	L&BN -----	Lead and Bench Nail
CULV -----	Culvert	L&BR -----	Lead and Brad
CYN -----	Canyon	L&N -----	Lead and Nail
CB -----	Curb	L&SPK -----	Lead and Spike
CS MON -----	Co. Eng. Monument	L&T -----	Lead and Tack
CT SPK -----	Cut Spike	MCR -----	Middle of Curb Return
DPW -----	Dept. of Public Works	MKD -----	Marked
DR -----	Drive or Driveway	MC -----	Middle of Curve
E/O -----	East of	MON -----	Monument

ABBREVIATIONS USED IN BENCH MARKS (CON'T)

N/O ----- North of
NR ----- Near
OPP ----- Opposite
PI ----- Point of Intersection
PK&W ----- PK Nail and Washer
P/L ----- Property Line
POST ----- Point of Semi-Tangent
PP ----- Power Pole
PVMT ----- Pavement
PROD ----- Produced
RD ----- Road
RDBM ----- Road Dept. Bench Mark
RDBM TAG ----- Road Dept. Bench Mark Tag
RR ----- Railroad
RT ----- Right
R/W ----- Right of Way
SDMH ----- Storm Drain Manhole
SMH ----- Sewer Manhole
SPK ----- Spike
ST&W ----- Spike Tin and Washer
S/O ----- South of
TP ----- Telephone Pole
USC&GS ----- U.S. Coast and Geodetic Survey
USGS ----- U.S. Geological Survey
WK ----- Walk
W/O ----- West of

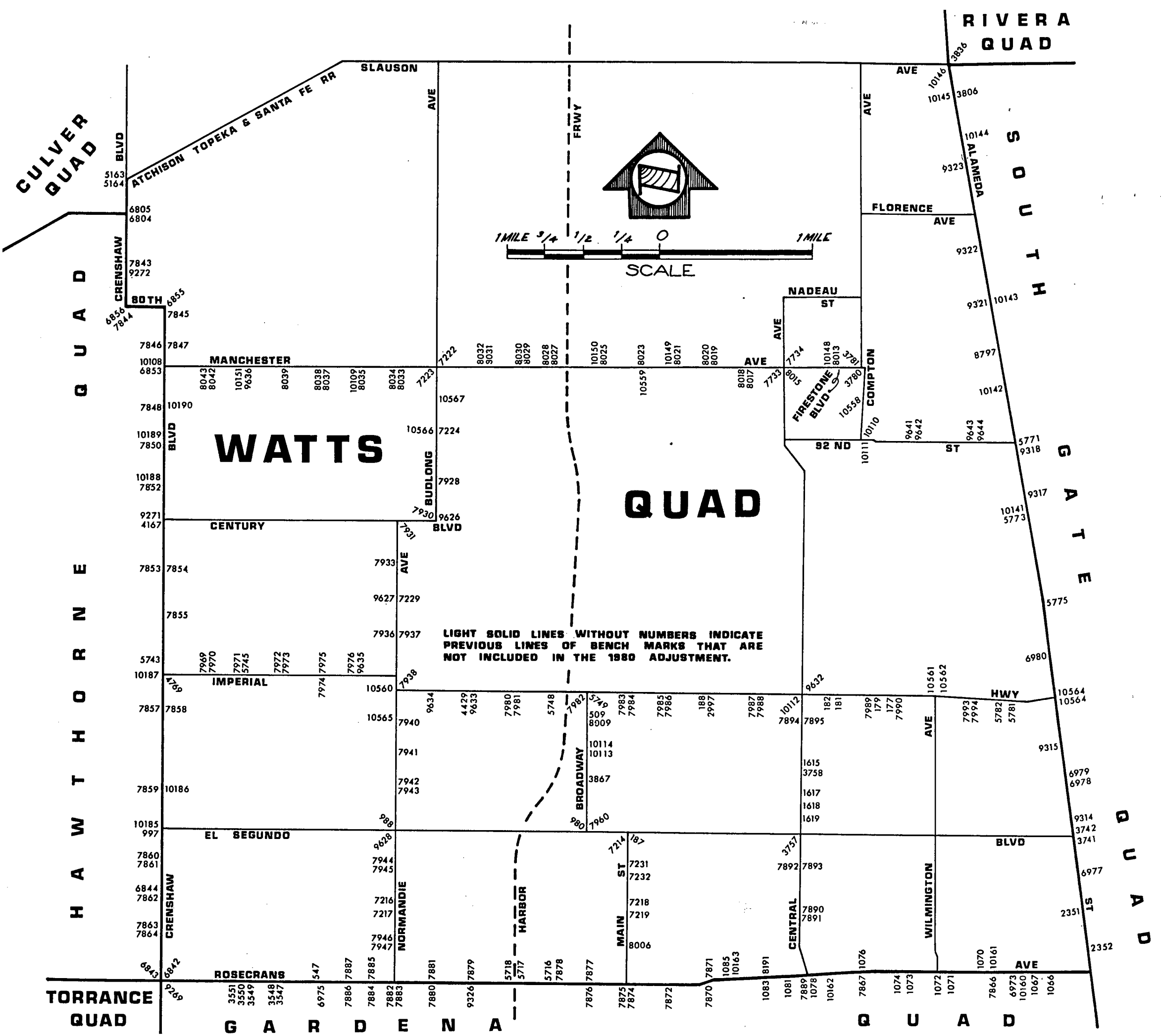

WATTS

QUAD

LIGHT SOLID LINES WITHOUT NUMBERS INDICATE PREVIOUS LINES OF BENCH MARKS THAT ARE NOT INCLUDED IN THE 1980 ADJUSTMENT.



CULVER QUAD

H A W T H O R N E

TORRANCE QUAD

G A R D E N A

Q U A D

RIVERA QUAD

S O U T H

G A T E

Q U A D

QUAD-YEAR	ELEV	DESCRIPTION (INCLUDE QUAD AND YEAR IN DESCRIPTION)	BM NUMBER
WATTS (1994)	0093.358	FLAT HD SPK IN S CB 40FT S/O C/L IMPERIAL HWY @ C/L PROD GRANDEE AVE	Y 177A
WATTS (1994)	0092.886	LA CITY ENG HEX MON IN WELL 14IN DN ON C/L IMPERIAL HWY 25FT W/O C/L COMPTON AVE TO THE N	Y 179A
WATTS (1994)	0093.448	L&BN IN S CB 3FT W/O BCR @ SW COR IMPERIAL HWY & SUCCESS AVE 40FT S & 40FT W/O C/L INT	Y 181A
WATTS (1994)	0093.957	L&BN IN S CB 3FT W/O BCR @ SW COR IMPERIAL HWY & PARMELEE AVE 40FT S & 35FT W/O C/L INT	Y 182A
WATTS (1994)	0134.585	RDBM TAG IN N CB 1FT W BCR @ NW COR EL SEGUNDO BLVD & MAIN ST 66FT W & 40FT N/O C/L INT	Y 187A
WATTS (1994)	0110.617	RD BM TAG IN W IN CB 1FT S/O BCR 61FT S & 30FT W/O C/L INT IMPERIAL HWY & AVALON BLVD	Y 188A
WATTS (1994)	0152.227	L&T IN W CB 15.4FT N/O BCR @ NW COR BROADWAY & 117TH ST 47FT N & 23FT W/O C/L INT	Y 509
BASELINE (1990)	0047.297	L&T IN CB 1FT SO BCR @ NE COR WESTERN AVE & ROSECRANS AVE 65FT N & 40FT E/O C/L INT	Y 547
WATTS (1994)	0147.137	RD BM TAG IN N CB 1FT W/O BCR @ EL SEGUNDO BLVD & BROADWAY 40FT N & 74FT W/O C/L INT	Y 980B
WATTS (1994)	0122.553	RDBM TAG IN N CB 1FT W/O BCR @ NW COR NORMANDIE AVE & EL SEGUNDO BLVD 56FT W & 38FT N/O C/L INT	Y 988B
BASELINE (1990)	0051.156	FC MON 12IN DN 175FT E/O C/L CRENSHAW BLVD & 50FT S/O C/L EL SEGUNDO BLVD ON W P/L OF LAFC CHANNEL (CO ENG #27-75A)	Y 997A
BASELINE (1990)	0069.748	L&T NR CTR OF RET @ NW COR WILLOWBROOK AVE (W BARREL) & ROSECRANS AVE 43FT N & 45FT W/O C/L INT	Y 1066
BASELINE (1990)	0069.525	L&T NR CTR OF RET @ NE COR ROSECRANS AVE & ACACIA ST 43FT N & 45FT E/O C/L INT	Y 1067
BASELINE (1990)	0072.950	L&BR IN CTR OF CB RET 7FT W/O BCR 42FT N & 25FT E/O C/L INT ROSECRANS AVE & MATTHISEN AVE	Y 1070
BASELINE (1990)	0075.125	L&T IN CTR OF CB RET @ NE COR WILMINGTON AVE & ROSECRANS AVE 46FT N & 40FT E/O C/L INT	Y 1071
BASELINE (1990)	0075.037	L&T IN CTR OF RET @ NW COR WILMINGTON AVE & ROSECRANS AVE 45FT N & 40FT W/O C/L INT	Y 1072

QUAD-YEAR	ELEV	DESCRIPTION (INCLUDE QUAD AND YEAR IN DESCRIPTION)	BM NUMBER
BASELINE (1990)	0075.905	CS MON IN WELL 38FT N/O C/L ROSECRANS AVE & 38FT W/O NW COR CONC BRIDGE OVER COMPTON CREEK 164FT E/O C/L DWIGHT ST MKD (CS MON BM 21-2 1952 RE 63)	Y 1073A
BASELINE (1990)	0077.370	L&BN IN N CB 2FT E/O BCR @ NE COR ROSECRANS AVE & DWIGHT ST 38FT N & 35FT E/O C/L INT	Y 1074A
BASELINE (1990)	0085.088	L&BN IN E CB 65FT S & 23FT E C/L INT ROSECRANS AVE & TAJAUTA AVE (0.4FT S/O BCR)	Y 1076
BASELINE (1990)	0100.372	CS MON IN WELL @ NE COR ROSECRANS AVE & CENTRAL AVE 105FT E & 44FT N/O C/L INT 32FT E/O BCR & 4FT N/O CB FACE MKD (BM 21-3 1952 RE 63)	Y 1078A
BASELINE (1990)	0105.441	L&BN 4IN S/O BCR @ SE COR ROSECRANS AVE & KEENE AVE 106FT S & 24FT E/O C/L INT	Y 1081
BASELINE (1990)	0109.903	L&T IN S CB ROSECRANS AVE (SERVICE RD) 1FT E/O BCR 76FT S C/L ROSECRANS AVE & 55FT E/O C/L CAHITA AVE (MKD BM)	Y 1083
BASELINE (1990)	0114.081	L&BN IN N CB 1FT W/O BCR @ NW COR ROSECRANS AVE & STANFORD AVE 40FT N & 52FT W/O C/L INT	Y 1085A
WATTS (1994)	0091.144	L&SPK IN CB IN S CB 3FT E/O BCR @ SE COR CENTRAL AVE & 120TH ST 66FT E & 28FT S/O C/L INT	Y 1615
WATTS (1994)	0089.829	L&BN 1FT N/O BCR @ NE COR 124TH ST (SERVICE RD) & CENTRAL AVE (SERVICE RD) 44FT N & 80FT E/O C/L INT	Y 1617
WATTS (1994)	0089.610	L&BN 1FT N/O BCR @ NE COR 126TH ST (SERVICE RD) & CENTRAL AVE (SERVICE RD) 80FT E & 41FT N/O C/L INT	Y 1618
WATTS (1994)	0089.403	L&BN IN CB 1FT N/O BCR @ NE COR CENTRAL AVE (SERVICE RD) & 127TH ST 83FT E & 43FT N/O C/L INT	Y 1619
BASELINE (1990)	0072.882	L&T IN E CB ALAMEDA ST 33FT S/O N CB ORIS ST PROD	Y 2351
BASELINE (1990)	0070.627	L&T IN E CB ALAMEDA ST ON C/L PROD MEALY ST	Y 2352
WATTS (1994)	0108.998	LACE MON IN WELL @ C/L INT IMPERIAL HWY & AVALON BLVD (N OF TWO MON 4FT APART)	Y 2997A

QUAD-YEAR	ELEV	DESCRIPTION (INCLUDE QUAD AND YEAR IN DESCRIPTION)	BM NUMBER
BASELINE (1990)	0044.878	L&T IN S CB 1FT E/O BCR @ SE COR ROSECRANS AVE & GRAMERCY PL 40FT S & 40FT E/O C/L INT	Y 3547A
BASELINE (1990)	0044.573	L&T IN W CB 1FT S/O BCR @ SW COR ROSECRANS AVE & GRAMERCY PL 60FT S & 18FT W/O C/L INT	Y 3548A
BASELINE (1990)	0045.047	RD BM TAG IN CB 7FT E/O BCR @ SE COR ROSECRANS AVE & VAN NESS AVE 75FT E & 40FT S/O C/L INT	Y 3549A
BASELINE (1990)	0046.196	RD BM TAG IN W CB 5FT N/O BCR @ NW COR VAN NESS AVE & ROSECRANS AVA 68FT N & 30FT W/O C/L INT	Y 3550A
BASELINE (1990)	0044.296	CS MON 90FT S/O C/L ROSECRANS AVE & 30FT W/O C/L VAN NESS AVE (1.5FT W/O CB FACE)	Y 3551
BASELINE (1990)	0079.774	BR CAP @ S END OF W CONC BANNISTER @ MAIN ENT TO BLDG #310 EXCEPTIONAL ADULT CTR ALAMEDA ST (E BBL) @ SE COR EL SEGUNDO 114FT E & 98FT S/O C/L INT MKD (W 615 1941)	Y 3741
WATTS (1994)	0092.058	BN IN CB 2FT S/O BCR @ SW COR CENTRAL AVE & EL SEGUNDO BLVD 65FT S & 38FT W/O C/L INT	Y 3757
WATTS (1994)	0091.019	L&BN IN W CB 2FT N BCR @ NE COR CENTRAL AVE & 121ST ST 61FT N & 38FT E/O C/L INT	Y 3758
WATTS (1994)	0128.479	L&T IN N CB FIRESTONE BLVD 35FT N/O C/L ON C/L PROD COMPTON AVE (FROM THE S)	Y 3780
WATTS (1994)	0129.002	L&T IN CB 5FT E/O BCR @ NW COR FIRESTONE BLVD & COMPTON AVE (TO THE N) 37FT N & 47FT W/O C/L INT	Y 3781
BASELINE (1990)	0178.696	DISC IN S WALL 3FT UP 2FT E/O SW COR BLDG #6000 ALAMEDA ST (E BBL) @ NE COR INT RANDOLPH ST 8FT N/O N CB & 8FT E/O E CB	Y 3806
BASELINE (1990)	0178.957	CS MON ON C/L SLAUSON AVE 13FT W/O W RAIL SPRR 29FT E/O C/L ALAMEDA ST MKD (WATTS H-2A 1939)	Y 3836
WATTS (1994)	0173.168	L&T IN E CB NR BCR @ NE COR BROADWAY & 124TH ST (TO THE W) 69FT N & 38FT E/O C/L INT	Y 3867
BASELINE (1990)	0167.204	LACS BM MON IN WELL 2FT BK/O CB FACE @ APPROX CTR OF SW CB RET CRENSHAW BLVD & CENTURY BLVD 50FT S & 47FT W/O C/L INT MKD (27-68 1953 RE 63)	Y 4167
WATTS (1994)	0197.030	BM TAG IN N CB 1FT W/O BCR @ NW COR VERMONT AVE (W BARREL) & IMPERIAL HWY 40FT N & 40FT W/O C/L INT	Y 4429

QUAD-YEAR	ELEV	DESCRIPTION (INCLUDE QUAD AND YEAR IN DESCRIPTION)	BM NUMBER
BASELINE (1990)	0076.482	FLT HD SPK S CB IMPERIAL HWY 10FT W/O BCR @ SW COR CRENSHAW BLVD 38FT S & 85FT W/O C/L INT	Y 4769
BASELINE (1990)	0160.169	USC&GS MON FL 49FT E & 118FT S/O C/L INT 67TH ST & CRENSHAW BLVD 12FT NW/O N RAIL AT&SFRR & 13FT E/O E CB CRENSHAW BLVD MKD (A-415 1935)	Y 5163
BASELINE (1990)	0159.225	USC&GS MON 13IN UP 187FT E & 39FT S/O C/L INT CRENSHAW BLVD & 67TH ST 67FT W/O INT S CB & AT&SFRR MKD (Z-414 1935)	Y 5164
BASELINE (1990)	0099.659	LACE MON IN WELL @ OR NR C/L INT FIGUEROA ST & ROSECRANS AVE MKD (TRAV STA WATTS C 12 B 1946)	Y 5716
BASELINE (1990)	0090.453	L&BT SPK IN N CB HARBOR FRWY OVERPASS 35.5FT W/O BCR 42FT N/O C/L ROSECRANS AVE 70FT E/O C/L FRWY	Y 5717
BASELINE (1990)	0089.118	L&SPK IN N CB 2FT E/O BCR @ NE COR ROSECRANS AVE & HOOVER ST 42FT N & 23FT E/O C/L INT (159FT W/O C/L HARBOR FRWY OVERPASS)	Y 5718
BASELINE (1990)	0079.018	LACS BM MON IN WELL IN PKWY @ NW COR CRENSHAW BLVD & 113TH ST 26FT N & 45FT W/O C/L INT MKD (BM 27-70A 1960 RE 5869)	Y 5743
WATTS (1994)	0119.048	L&T IN CB 2FT N/O BCR @ NE COR IMPERIAL HWY & VAN NESS AVE 80FT N & 30FT E/O C/L INT	Y 5745
WATTS (1994)	0155.444	BT SPK IN E CB 1FT N/O BCR @ NE COR IMPERIAL HWY & FIGUEROA ST 33FT E & 60FT N/O C/L INT	Y 5748
WATTS (1994)	0141.197	CT SPK IN S CB 25FT E/O BCR @ SE COR BROADWAY & IMPERIAL HWY 36FT S & 60FT E/O C/L INT	Y 5749
BASELINE (1990)	0119.671	CS MON IN SW CONC LEG OF EDISON TOWER #265 D3 110FT N C/L SOUTHERN AVE & 33FT E/O C/L ALAMEDA ST (E BARREL) MKD (LC 796 1945)	Y 5771
BASELINE (1990)	0102.863	CS MON IN CONC POST 2IN UP 1FT E/O E CB ALAMEDA ST (W BBL) & 199FT N/O C/L MARTIN LUTHER KING BLVD (RE 2177-6)	Y 5775
WATTS (1994)	0087.752	L&T IN S CB 1FT W/O BCR @ SW COR MONA AVE & IMPERIAL HWY 40 FT S & 30FT W/O C/L INT	Y 5781
WATTS (1994)	0089.189	L&T IN S CB 40FT S & 268FT W/O C/L INT MONA BL & IMPERIAL HWY (2FT W/O PP #4258021E)	Y 5782

QUAD-YEAR	ELEV	DESCRIPTION (INCLUDE QUAD AND YEAR IN DESCRIPTION)	BM NUMBER
BASELINE (1990)	0159.226	LACE HEX BAR MON IN WELL @ C/L INT CRENSHAW BL & FLORENCE AVE (CO ENG #26-62)	Y 6804
BASELINE (1990)	0158.276	WIRE SPK IN W CB 5FT N/O BCR @ NW COR CRENSHAW BLVD & FLORENCE AVE 60FT N & 38FT W/O C/L INT	Y 6805
BASELINE (1990)	0050.024	LACS BM MON FL IN FC CH WALL 6FT N/O CB E SIDE CHANNEL 46FT N & 191FT E/O C/L INT ROSECRANS AVE & CRENSHAW BLVD MKD (21-11A 1964 RE 5869)	Y 6842
BASELINE (1990)	0049.750	L&BN IN E CB 1FT N/O BCR @ NE COR CRENSHAW BLVD & ROSECRANS AVE 76FT N & 38FT E/O C/L INT	Y 6843
BASELINE (1990)	0045.832	LACS BM MON IN WELL 62FT W/O C/L CRENSHAW BLVD & 6FT S/O C/L PROD 134TH ST MKD (BM 27-76A 1960 RE 5869)	Y 6844
BASELINE (1990)	0214.213	LACS BM MON IN WELL 1FT W/O CB FACE @ SW COR CRENSHAW BLVD & MANCHESTER BLVD 104FT S & 40FT W/O C/L INT MKD (BM 27-66 1953)	Y 6853
BASELINE (1990)	0225.028	LACE HEX BAR MON IN WELL @ C/L INT 81ST E & 8TH AVE (27-65 CO ENG-CLA 18-10730)	Y 6855
BASELINE (1990)	0242.662	LACE BM MON FL IN CONC 3FT W/O CB @ SW COR 80TH ST & CRENSHAW BLVD 38FT W & 45FT S/O C/L INT MKD (24320 FT 13-C 27-64) CITY LA # 18-10770	Y 6856
BASELINE (1990)	0070.369	CS MON 8IN DN @ NE COR ROSECRANS AVE & OLEANDER ST 39FT N & 71FT E/O C/L INT MKD (BM 21-1 1952)	Y 6973
BASELINE (1990)	0045.888	CS MON 10IN DN 1FT N/O CB @ NE COR ROSECRANS AVE & WESTERN AVE 179FT E & 41FT N/O C/L INT MKD (BM 21-9A 1960 RE 5869)	Y 6975
BASELINE (1990)	0073.460	CS MON FL IN C B @ NE COR ALAMEDA ST (E BARREL) & EUCLID AVE 45FT N & 27FT E/O C/L INT MKD (BM 5-19A 1964)	Y 6977
BASELINE (1990)	0082.002	L&BN IN E CB 1FT S/O BCR @ SE COR ALAMEDA ST (E BARREL) & DIXON AVE 40 FT S & 20FT E/O APPROX C/L INT MKD (BM)	Y 6978
BASELINE (1990)	0082.498	RD BM TAG IN CONC APRON @ SE COR ALAMEDA ST (E BARREL) & DIXON AVE 15FT S & 50FT E/O APPROX C/L INT MKD (BM)	Y 6979
BASELINE (1990)	0095.685	L&BN IN W CB 1FT N/O BCR @ NW COR ALAMEDA ST (W BARREL) & SANTA ANA BLVD 30FT W & 105FT N/O APPROX C/L INT	Y 6980

QUAD-YEAR	ELEV	DESCRIPTION (INCLUDE QUAD AND YEAR IN DESCRIPTION)	BM NUMBER
WATTS (1994)	0134.460	L&BN IN W CB 55FT S/O BCR @ SW COR EL SEGUNDO BLVD & MAIN ST 135FT S & 35FT W/O C/L INT	Y 7214
WATTS (1994)	0060.898	FC MON IN RD WELL 8IN DN @ C/L INT NORMANDIE AVE & 135TH ST MKD (LA CO FC DIST)	Y 7216
WATTS (1994)	0060.495	L&T IN W CB 0.6FT S/O BCR @ SW COR NORMANDIE AVE & 135TH ST 65FT S & 30FT W/O C/L INT	Y 7217
WATTS (1994)	0117.176	L&BN IN E CB 20FT S/O BCR @ SE COR MAIN ST & 135TH ST 87FT S & 40FT E/O C/L INT	Y 7218
WATTS (1994)	0117.686	RD BM TAG IN E CB 1FT S/O BCR @ SE COR MAIN ST & 136TH ST 82FT E & 42FT S/O C/L INT	Y 7219
WATTS (1994)	0149.701	LACE MON 12IN DN @ C/L INT MANCHESTER AVE & BUDLONG AVE	Y 7222
WATTS (1994)	0150.122	L&BN IN S CB 1.5FT W/O BCR @ SW COR BUDLONG AVE & MANCHESTER AVE 35FT S & 42FT W/O C/L INT	Y 7223
WATTS (1994)	0158.779	L&T IN W CB 21FT N/O BCR @ NW COR BUDLONG AVE & 92ND ST 56FT N & 20FT W/O C/L INT	Y 7224
WATTS (1994)	0214.151	L&T IN E CB NORMANDIE AVE 30FT E/O C/L ON C/L PROD 108TH ST	Y 7229
WATTS (1994)	0135.863	RD BM TAG IN W CB 1FT N/O BCR @ NW COR MAIN ST & 131ST ST 63FT N & 40FT W/O C/L INT	Y 7231
WATTS (1994)	0133.246	RD BM TAG IN W CB 1FT S/O BCR @ SW COR MAIN ST & 131ST ST 40FT W & 62FT S/O C/L INT	Y 7232
WATTS (1994)	0129.646	LA CITY DEPT OF PUBLIC WORKS MON FL 2FT W/O CB 154FT N & 35FT W/O C/L INT MANCHESTER AVE & CENTRAL AVE (MKD NO 11 M 130.60 ELEV)	Y 7733
WATTS (1994)	0128.890	L&SPK IN CB 2FT S/O BCR 59FT S & 35FT E/O C/L INT CENTRAL AVE & MANCHESTER AVE	Y 7734
BASELINE (1990)	0206.518	LACE MON IN WELL 10IN DN @ C/L INT CRENSHAW BLVD & 76TH ST	Y 7843
BASELINE (1990)	0240.419	RD BM TAG IN CB 4FT E/O BCR @ NE COR CRENSHAW BLVD & 80TH ST 69FT E & 18FT N/O C/L INT	Y 7844
BASELINE (1990)	0224.444	L&BN IN CB 2FT W/O BCR 18FT S & 49FT W/O C/L INT 8TH AVE & 80TH ST (TO THE WEST)	Y 7845

QUAD-YEAR	ELEV	DESCRIPTION (INCLUDE QUAD AND YEAR IN DESCRIPTION)	BM NUMBER
BASELINE (1990)	0210.145	L&BR IN E CB 8TH AVE 20FT E/O C/L ON C/L PROD 84TH ST (TO THE WEST)	Y 7846
BASELINE (1990)	0209.967	L&BR IN CB 2FT S/O BCR 47FT S & 20FT W/O C/L INT 8TH AVE & 84TH ST (TO THE W)	Y 7847
BASELINE (1990)	0213.629	L&T IN CB 4FT N/O BCR 83FT N & 38FT E/O C/L INT CRENSHAW BLVD & 90TH ST (TO THE E)	Y 7848
BASELINE (1990)	0206.305	L&PK IN CB 4FT N/O BCR 33FT N & 38FT E/O C/L INT CRENSHAW BLVD & ARBOR VITAE ST (TO THE EAST)	Y 7850
BASELINE (1990)	0194.091	L&DN IN NE COR C B 44FT S & 42FT E/O C/L INT CRENSHAW BLVD & HARDY ST	Y 7852
BASELINE (1990)	0127.447	L&DN IN NE COR C B 75FT N & 42 FT E/O C/L INT CRENSHAW BLVD & 104TH ST	Y 7853
BASELINE (1990)	0124.688	L&BR IN CB 8FT S/O BCR OF ISLAND 34FT S & 41FT E/O C/L CRENSHAW BLVD & 104TH ST	Y 7854
BASELINE (1990)	0091.910	SPK&L IN E CB 10FT S & 38FT E/O C/L CRENSHAW BLVD & 109TH ST (TO THE WEST)	Y 7855
BASELINE (1990)	0070.800	L&BR IN E CB 40FT E/O C/L CRENSHAW BLVD @ C/L PROD 116TH ST (TO THE WEST)	Y 7857
BASELINE (1990)	0070.087	L&SPK IN W CB @ SW COR CRENSHAW BLVD & 116TH ST (TO THE W) 65FT S & 38FT W/O C/L INT	Y 7858
BASELINE (1990)	0053.971	RD BM TAG IN BASE OF TRAFFIC LIGHT @ SW COR CRENSHAW BLVD & NORTHROP AVE 53FT S & 43FT W/O C/L INT	Y 7859
BASELINE (1990)	0049.444	L AFC BR CAP MON FL IN N ABUT TO BRIDGE OVER FC CHANNEL 50FT E/O C/L CRENSHAW BLVD & 191FT N/O C/L 132ND ST MKD (BM 114-63)	Y 7860
BASELINE (1990)	0046.524	L&BN IN N WALL OF L AFC CHANNEL 49FT W/O C/L CRENSHAW BLVD & 187FT N/O C/L 132ND ST	Y 7861
BASELINE (1990)	0046.314	RD BM TAG IN W CB 8FT N & 40FT W/O C/L INT CRENSHAW BLVD & 134TH ST	Y 7862
BASELINE (1990)	0047.213	CS BR CAP MON IN NE COR C B 65FT W & 19FT N/O C/L INT CRENSHAW BLVD & 139TH ST MKD (BM 27-27A 1965 RE 5869)	Y 7863
BASELINE (1990)	0047.163	L&SPK IN N END OF C B 1FT W/O CB @ SW COR 139TH ST & CRENSHAW BLVD 41FT W & 36FT S/O C/L INT	Y 7864

QUAD-YEAR	ELEV	DESCRIPTION (INCLUDE QUAD AND YEAR IN DESCRIPTION)	BM NUMBER
BASELINE (1990)	0072.164	L&BN IN S CB 5FT E/O BCR @ SE COR ROSECRANS AVE & ARANBE AVE 38FT S & 35FT E/O C/L INT	Y 7866
BASELINE (1990)	0085.374	L&T IN CB 9FT W/O BCR 40FT S & 68FT W/O C/L INT ROSECRANS AVE & TAJAUTA AVE	Y 7867
BASELINE (1990)	0113.954	RD BM TAG IN CB 5FT N/O BCR 65FT S & 41FT E/O C/L INT ROSECRANS AVE & AVALON BLVD	Y 7870
BASELINE (1990)	0112.798	RD BM TAG IN CB FT W/O BCR 40FT S & 80FT W/O C/L ROSECRANS AVE & AVALON BLVD	Y 7871
BASELINE (1990)	0105.483	RD BM TAG IN CB 4FT S/O BCR 86FT S & 32FT E/O C/L INT ROSECRANS AVE & SAN PEDRO ST	Y 7872
BASELINE (1990)	0112.423	RD BM TAG IN CB 3FT E/O BCR 40FT N & 76FT E/O C/L INT ROSECRANS AVE & MAIN ST	Y 7874
BASELINE (1990)	0112.180	CS MON IN WELL 8IN DN 2FT W/O CB 74FT S & 42FT W/O C/L INT ROSECRANS AVE & MAIN ST (MKD BM 21-5A 1970)	Y 7875
BASELINE (1990)	0114.692	L&T @ MCR 52FT S & 46FT E/O C/L INT ROSECRANS AVE & BROADWAY	Y 7876
BASELINE (1990)	0113.947	RD BM TAG IN CB 4FT S/O BCR 80FT S & 40FT W/O C/L INT ROSECRANS AVE & BROADWAY	Y 7877
BASELINE (1990)	0100.680	RD BM TAG IN CB 2FT S/O BCR 65FT S & 40FT E/O C/L INT ROSECRANS AVE & FIGUEROA ST	Y 7878
BASELINE (1990)	0060.202	RD BM TAG IN CB 3FT W/O BCR 42FT S & 48FT W/O C/L INT ROSECRANS AVE & VERMONT AVE (W BARREL)	Y 7879
BASELINE (1990)	0052.014	RD BM TAG 1FT E/O BCR 40FT S & 45FT E/O C/L INT ROSECRANS AVE & BUDLONG AVE	Y 7880
BASELINE (1990)	0051.392	RD BM TAG 1FT S/O BCR 66FT S & 18FT W/O C/L INT ROSECRANS AVE & BUDLONG AVE	Y 7881
BASELINE (1990)	0047.233	RD BM TAG IN CB 40FT S/O BCR 108FT S & 30FT E/O C/L INT ROSECRANS AVE & NORMANDIE AVE	Y 7882
BASELINE (1990)	0046.986	RD BM TAG IN CB 3FT E/O BCR 40FT S & 62FT W/O C/L INT ROSECRANS AVE & NORMANDIE AVE	Y 7883
BASELINE (1990)	0045.938	RD BM TAG IN CB 23FT E/O BCR 40FT S & 66FT E/O C/L INT ROSECRANS AVE & HALLDALE AVE	Y 7884

QUAD-YEAR	ELEV	DESCRIPTION (INCLUDE QUAD AND YEAR IN DESCRIPTION)	BM NUMBER
BASELINE (1990)	0045.729	RD BM TAG IN W CB @ N END C B 5FT S BCR 71FT S & 18FT W/O C/L INT ROSECRANS AVE & HALLDALE AVE	Y 7885
BASELINE (1990)	0045.185	RD BM TAG 1FT N/O BCR 64FT S & 18FT E/O C/L INT ROSECRANS AVE & DENKER AVE	Y 7886
BASELINE (1990)	0045.702	RD BM TAG IN CB 5FT W/O BCR 40FT S & 49FT W/O C/L INT ROSECRANS AVE & DENKER AVE	Y 7887
BASELINE (1990)	0102.638	RD BM TAG IN CB 3FT N/O BCR 94FT S & 38FT E/O C/L CENTRAL AVE & ROSECRANS AVE	Y 7889
WATTS (1994)	0098.510	L&ENG TAG 1FT N/O BCR 47FT N & 38FT E/O C/L INT CENTRAL AVE & PIRU ST	Y 7890
WATTS (1994)	0097.488	L&BN IN CB 2FT N/O BCR 56FT N & 80FT W/O C/L INT CENTRAL AVE (SERVICE RD) & 135TH ST	Y 7891
WATTS (1994)	0094.361	L&T IN CB 15FT S/O BCR 72FT S & 38FT E/O C/L INT CENTRAL AVE & 131ST ST (MKD S D 523)	Y 7892
WATTS (1994)	0093.715	RD BM TAG 5FT S/O BCR OF ISLAND @ N END C B 44FT S & 38FT W/O C/L INT CENTRAL AVE & 131ST ST (TO THE WEST)	Y 7893
WATTS (1994)	0092.832	RD BM TAG IN W CB 5FT S/O BCR @ SW COR CENTRAL AVE & 118TH ST 48FT S & 40FT W/O C/L INT	Y 7894
WATTS (1994)	0092.863	RD BM TAG IN CB 5FT E/O BCR 15FT N & 65FT E/O C/L INT CENTRAL AVE & 118TH ST	Y 7895
WATTS (1994)	0160.054	RD BM TAG IN CB 3FT E/O BCR 20FT S & 43FT E/O C/L INT BUDLONG AVE & 95TH ST	Y 7928
WATTS (1994)	0167.085	L&BN IN CB 30FT S/O BCR 80FT S & 20FT W/O C/L INT CENTURY BLVD & BUDLONG AVE	Y 7930
WATTS (1994)	0189.630	RD BM TAG IN CB 2FT W/O BCR 30FT N & 48FT E/O C/L INT CENTURY BLVD & NORMANDIE AVE	Y 7931
WATTS (1994)	0197.019	RD BM TAG IN CB 2FT E/O BCR 15FT S & 52FT E/O C/L INT NORMANDIE AVE & 104TH ST	Y 7933
WATTS (1994)	0213.498	RD BM TAG IN CB 1FT W/O BCR 15FT N & 55FT W/O C/L INT NORMANDIE AVE & 110TH PL	Y 7936
WATTS (1994)	0212.675	L&T IN E CB 30FT E/O C/L NORMANDIE AVE ON C/L PROD 110TH PL	Y 7937

QUAD-YEAR	ELEV	DESCRIPTION (INCLUDE QUAD AND YEAR IN DESCRIPTION)	BM NUMBER
WATTS (1994)	0201.029	RD BM TAG IN CB 1FT S/O BCR 60FT S & 30FT W/O C/L NORMANDIE AVE & IMPERIAL HWY	Y 7938
WATTS (1994)	0170.642	L&T 0.5FT S/O BCR OF DRWY 40FT S & 30FT E/O C/L INT NORMANDIE AVE & SPRR (0.3MI S/O C/L IMPERIAL HWY)	Y 7940
WATTS (1994)	0192.183	RD BM TAG IN CB 10FT W/O BCR 32FT N & 77FT W/O C/L INT NORMANDIE AVE & 120TH ST	Y 7941
WATTS (1994)	0151.933	L&T IN CB 1FT W/O BCR 20FT N & 56FT W/O C/L INT NORMANDIE AVE & 125TH ST	Y 7942
WATTS (1994)	0153.403	RD BM TAG IN CB 2FT W/O BCR 20FT S & 53FT E/O C/L INT NORMANDIE AVE & 125TH ST	Y 7943
WATTS (1994)	0087.150	RD BM TAG 4FT N/O BCR @ S END C B 58FT N & 30FT E/O C/L INT NORMANDIE AVE & 132ND ST	Y 7944
WATTS (1994)	0085.263	RD BM TAG IN CB 2FT E/O BCR 30FT S & 57FT E/O C/L INT NORMANDIE AVE & 132ND ST	Y 7945
WATTS (1994)	0050.154	RD BM TAG IN E CB @ S EDGE C B 47FT N & 30FT E/O C/L INT NORMANDIE AVE & 139TH ST	Y 7946
WATTS (1994)	0050.225	SPK&L IN CB 9FT S/O BCR @ SW COR NORMANDIE AVE & 139TH ST 54FT S & 30FT W/O C/L INT	Y 7947
WATTS (1994)	0146.322	RD BM TAG IN CB 4FT N/O BCR 72FT N & 40FT E/O C/L INT EL SEGUNDO BLVD & BROADWAY	Y 7960
WATTS (1994)	0105.209	L&BR IN CB 14FT W/O BCR OF ISLAND 41FT S & 49FT W/O C/L INT IMPERIAL HWY & CASIMIR AVE	Y 7969
WATTS (1994)	0105.611	L&BR IN CB 5FT E/O BCR OF ISLAND 40FT S & 41FT E/O C/L INT IMPERIAL HWY & CASIMIR AVE	Y 7970
WATTS (1994)	0116.549	RD BM TAG IN S CB (SERVICE RD) 2FT W BCR 80FT S & 124FT W/O C/L INT IMPERIAL HWY & VAN NESS AVE	Y 7971
WATTS (1994)	0151.599	RDBM TAG IN S CB (SERVICE RD) 4FT W/O BCR 80FT S & 40FT W/O C/L INT IMPERIAL HWY & WILTON PL	Y 7972
WATTS (1994)	0155.543	RD BM TAG IN CB 3FT E/O BCR 38FT S & 58FT E/O C/L INT IMPERIAL HWY & WILTON PL	Y 7973
WATTS (1994)	0201.312	RD BM TAG IN CB 3FT S/O BCR 73FT S & 42FT W/O C/L INT IMPERIAL HWY & WESTERN AVE	Y 7974

QUAD-YEAR	ELEV	DESCRIPTION (INCLUDE QUAD AND YEAR IN DESCRIPTION)	BM NUMBER
WATTS (1994)	0202.982	L&BN IN CB 30FT E/O BCR 40FT S & 110FT E/O C/L INT IMPERIAL HWY & WESTERN AVE MKD (BM)	Y 7975
WATTS (1994)	0210.004	RD BM IN CB TAG 5FT W/O BCR 40FT N & 50FT W/O C/L INT IMPERIAL HWY & DENKER AVE	Y 7976
WATTS (1994)	0173.953	FLT HD SPK IN CB 3FT N/O BCR 55FT N & 28FT E/O C/L INT IMPERIAL HWY & HOOVER ST	Y 7980
WATTS (1994)	0174.519	L&T IN CB 2.5FT E/O BCR 34FT S & 43FT E/O C/L INT IMPERIAL HWY & HOOVER ST	Y 7981
WATTS (1994)	0141.070	BT SPK IN CB 12FT E/O BCR @ W END C B 30FT N & 48FT E/O C/L INT IMPERIAL HWY & BROADWAY	Y 7982
WATTS (1994)	0128.409	FLT HD SPK IN CB 30FT S/O BCR 82FT S & 25FT W/O C/L INT IMPERIAL HWY & MAIN ST	Y 7983
WATTS (1994)	0127.081	RD BM TAG IN CB 4FT E/O BCR OF ISLE 40FT S & 75FT E/O C/L INT IMPERIAL HWY & MAIN ST	Y 7984
WATTS (1994)	0123.814	RD BM TAG IN CB 1FT S/O BCR 32FT W/O C/L SAN PEDRO ST & 10FT S/O C/L IMPERIAL HWY PROD	Y 7985
WATTS (1994)	0122.849	RD BM TAG IN CB 16FT E/O BCR 40FT S & 66FT E/O C/L IMPERIAL HWY & SAN PEDRO ST	Y 7986
WATTS (1994)	0102.404	SPK&L IN C B 6FT W/O BCR 55FT N & 56FT W/O C/L INT IMPERIAL HWY & WADSWORTH AVE	Y 7987
WATTS (1994)	0101.647	RD BM TAG IN CB 4FT E/O BCR 44FT S & 79FT E/O C/L INT IMPERIAL HWY & WADSWORTH AVE	Y 7988
WATTS (1994)	0094.093	STATE DIV OF HWYS STEEL PLATE & W 20FT N/O BCR 82FT N & 19FT W/O C/L INT IMPERIAL HWY & COMPTON AVE (TO THE N)	Y 7989
WATTS (1994)	0093.132	FLT HD SPK IN CB 9FT N/O BCR IN N END C B 69FT N & 10FT W/O C/L INT IMPERIAL HWY & GRANDEE AVE	Y 7990
WATTS (1994)	0089.427	FLT HD SPK IN S CB @ W END C B 40FT S & 331FT W/O C/L INT IMPERIAL HWY & CROESUS AVE OPP HSE #2077	Y 7993
WATTS (1994)	0090.144	L&T IN N CB 40FT N & 331FT W/O C/L INT IMPERIAL HWY & CROESUS AVE @ HSE #2077	Y 7994
WATTS (1994)	0113.649	L&BN IN CB 9FT S/O BCR 64FT S & 40FT E/O C/L INT MAIN ST & 140TH ST	Y 8006

QUAD-YEAR	ELEV	DESCRIPTION (INCLUDE QUAD AND YEAR IN DESCRIPTION)	BM NUMBER
WATTS (1994)	0152.266	L&N IN CB @ MCR 23FT S & 28FT E/O C/L INT 117TH ST & BROADWAY	Y 8009
WATTS (1994)	0129.184	L&CE TAG IN N CB 37FT N/O C/L FIRESTONE BLVD ON C/L PROD ZAMORA AVE (TO THE SOUTH)	Y 8013
WATTS (1994)	0128.989	L&T IN CB 1FT E/O BCR @ NE COR MANCHESTER AVE & CENTRAL AVE 56FT E & 35FT N/O C/L INT	Y 8015
WATTS (1994)	0129.428	L&T IN CB 1FT N/O BCR @ NW COR MANCHESTER AVE & MCKINLEY AVE 50FT N & 15FT W/O C/L INT	Y 8017
WATTS (1994)	0129.671	SPK&L IN CB 13FT W/O BCR 35FT S & 46FT W/O C/L INT MCKINLEY PL & MANCHESTER AVE	Y 8018
WATTS (1994)	0131.994	SPK&L IN CB 20FT N/O BCR 70FT N & 33FT W/O C/L INT MANCHESTER AVE & AVALON BLVD	Y 8019
WATTS (1994)	0131.738	SPK&L IN CB 1FT W/O BCR 35FT S & 53FT W/O C/L INT MANCHESTER AVE & AVALON BLVD	Y 8020
WATTS (1994)	0130.646	SPK&L IN CB 10FT E/O BCR 35FT N & 64FT E/O C/L INT MANCHESTER AVE & SAN PEDRO ST	Y 8021
WATTS (1994)	0131.743	CUT SPK IN NE COR C B 68FT N 31FT E/O C/L INT MANCHESTER AVE & MAIN ST	Y 8023
WATTS (1994)	0130.667	CUT SPK IN NW COR C B 39FT N & 68FT E/O C/L INT MANCHESTER AVE & BROADWAY	Y 8025
WATTS (1994)	0130.500	CUT SPK IN NW COR C B 39FT N & 62FT E/O C/L INT MANCHESTER AVE & FIGUEROA ST	Y 8027
WATTS (1994)	0130.243	L&T IN CB 1FT S/O BCR 61FT S & 32FT W/O C/L INT MANCHESTER AVE & FIGUEROA ST	Y 8028
WATTS (1994)	0132.969	SQ SPK&L IN CB 15FT S/O BCR 70FT S & 24FT E/O C/L INT MANCHESTER AVE & HOOVER ST (TO THE S)	Y 8029
WATTS (1994)	0133.505	L&T IN CB 40FT W/O BCR 35FT S & 75FT W/O C/L INT MANCHESTER AVE & HOOVER ST (TO THE N)	Y 8030
WATTS (1994)	0137.963	RD BM TAG IN E CB 51FT S & 35FT E/O C/L INT MANCHESTER AVE (E BARREL) & VERMONT AVE	Y 8031
WATTS (1994)	0139.812	SPK&L IN W CB 70FT S & 52FT W/O C/L INT VERMONT AVE & MANCHESTER AVE (W BARREL)	Y 8032
WATTS (1994)	0162.998	SPK&L IN CB 15FT S/O BCR 71FT S & 27FT E/O C/L INT MANCHESTER AVE & NORMANDIE AVE	Y 8033

QUAD-YEAR	ELEV	DESCRIPTION (INCLUDE QUAD AND YEAR IN DESCRIPTION)	BM NUMBER
WATTS (1994)	0163.599	RD BM TAG IN CB 1FT E/O BCR 35FT S & 55FT W/O C/L INT MANCHESTER AVE & NORMANDIE AVE	Y 8034
WATTS (1994)	0174.496	RD BM TAG IN NE COR C B 64FT S & 24FT E/O C/L INT MANCHESTER AVE & DENKER AVE	Y 8035
WATTS (1994)	0187.524	RD BM TAG IN CB 2FT E/O BCR 35FT S & 58FT E/O C/L INT MANCHESTER AVE & WESTERN AVE	Y 8037
WATTS (1994)	0188.769	RDBM TAG 2.5FT W/O BCR 35FT N & 58FT W/O C/L INT MANCHESTER AVE & WESTERN AVE	Y 8038
WATTS (1994)	0203.854	FLT HD SPK IN CB 8FT N/O BCR 58FT N & 18FT E/O C/L INT MANCHESTER AVE & GRAMERCY PL	Y 8039
WATTS (1994)	0219.453	SPK&L IN CB 4FT N/O BCR 68FT N & 18FT E/O C/L INT MANCHESTER AVE & FIFTH AVE	Y 8042
WATTS (1994)	0219.497	RD BM TAG IN CB 3FT W/O BCR 38FT S & 33FT W/O C/L INT MANCHESTER AVE & FIFTH AVE	Y 8043
BASELINE (1990)	0110.939	L&T IN S CB ROSECRANS AVE (N CB ISLAND) 42.5FT S & 52FT W/O C/L INT ROSECRANS AVE & CAHITA AVE	Y 8191
BASELINE (1990)	0127.652	L&T 28FT E/O C/L ALAMEDA ST ON C/L PROD 85TH ST	Y 8797
BASELINE (1990)	0051.015	LACS BM MON IN SLY WALL DOMINGUEZ CHANNEL 1FT SW OF SW COR BRIDGE #1276 @ SW COR ROSECRANS AVE & CRENSHAW BLVD 241FT S & 43FT W/O C/L INT MKD (21-12A 1964 RE 5869)	Y 9269
BASELINE (1990)	0170.538	L&SPK IN CB RET 2FT W/O BCR @ NE COR CRENSHAW BLVD & CENTURY BLVD 66FT E & 38FT N/O C/L INT	Y 9271
BASELINE (1990)	0207.963	RD BM TAG IN S CB 1FT E/O BCR @ SE COR CRENSHAW BLVD & 76TH ST (TO THE E) 51FT E & 18FT S/O C/L INT	Y 9272
BASELINE (1990)	0078.036	RAMSET IN CB 6FT S/O BCR @ SE COR ALAMEDA ST (E BBL) & BANNING ST 52FT S & 24FT E/O C/L INT	Y 9314
BASELINE (1990)	0112.835	RD BM TAG IN CB 4FT S/O BCR @ SE COR ALAMEDA ST (E BARREL) & KANSAS AVE 37FT S & 18FT E/O C/L INT	Y 9317
BASELINE (1990)	0117.991	RD BM TAG IN N WALL C B 4FT S/O BCR @ SE COR ALAMEDA ST (E BARREL) & SOUTHERN AVE 45FT S & 19FT E/O C/L INT	Y 9318

QUAD-YEAR	ELEV	DESCRIPTION (INCLUDE QUAD AND YEAR IN DESCRIPTION)	BM NUMBER
BASELINE (1990)	0149.270	L&T 28FT E/O C/L ALAMEDA ST NEAR C/L PROD ZOE AVE	Y 9322
BASELINE (1990)	0161.109	L&T 20FT W/O C/L ALAMEDA ST (E BARREL) ON OR NEAR C/L PROD ZOE AVE	Y 9323
BASELINE (1990)	0062.547	RD BM TAG IN CB 1FT E/O BCR @ NE COR ROSECRANS AVE & VERMONT AVE (E BARREL) 50FT E & 42FT N/O C/L INT	Y 9326
WATTS (1994)	0166.240	L&T IN CB 5FT W/O BCR @ SE COR CENTURY BLVD & BUDLONG AVE 39FT S & 37FT E/O C/L INT BUDLONG AVE (TO THE SOUTH)	Y 9626
WATTS (1994)	0214.456	RD BM TAG IN CB 2FT S/O BCR @ SW COR NORMANDIE AVE & 108TH ST 55FT S & 30FT W/O C/L INT	Y 9627
WATTS (1994)	0119.241	RD BM TAG IN CB 6FT S/O BCR @ SW COR NORMANDIE AVE & EL SEGUNDO BLVD 70FT S & 30FT W/O C/L INT	Y 9628
WATTS (1994)	0097.772	RAMSET IN CTR CB RET @ NE COR IMPERIAL HWY & CENTRAL AVE 53FT N & 44FT E/O C/L INT	Y 9632
WATTS (1994)	0198.149	L&LACE TAG IN CB 5FT S/O BCR OF ISLAND 51FT S & 36FT E/O C/L INT VERMONT AVE (W BARREL) & IMPERIAL HWY	Y 9633
WATTS (1994)	0187.753	L&LACE TAG IN CB 38FT N/O C/L IMPERIAL HWY ON C/L PROD BUDLONG AVE (TO THE SOUTH)	Y 9634
WATTS (1994)	0207.484	RD BM TAG IN CB 2FT E/O BCR @ NE COR IMPERIAL HWY & DENKER AVE 47FT E & 38FT N/O C/L INT	Y 9635
WATTS (1994)	0213.281	L&PK IN CB 42FT E/O BCR @ SE COR MANCHESTER AVE & VAN NESS AVE 82FT E & 35FT S/O C/L INT	Y 9636
WATTS (1994)	0120.313	RD BM TAG IN CB 3FT W/O BCR @ SW COR 92ND ST & HOLMES AVE 38FT W & 32FT S/O C/L INT	Y 9641
WATTS (1994)	0120.380	RD BM TAG IN CB 3FT W/O BCR @ NW COR 92ND ST & HOLMES AVE 32FT N & 48FT W/O C/L INT	Y 9642
WATTS (1994)	0115.682	RD BM TAG IN CB 3FT W/O BCR @ SW COR 92ND ST & HICKORY ST 50FT W & 32FT S/O C/L INT	Y 9643
WATTS (1994)	0115.428	RD BM TAG IN CB 3FT E/O BCR @ SE COR 92ND ST & HICKORY ST 48FT E & 32FT S/O C/L INT	Y 9644
BASELINE (1990)	0215.051	RD BM TAG IN E CB 2FT N/O BCR @ NE COR CRENSHAW BLVD & MANCHESTER BLVD 76FT N & 38FT E/O C/L INT	Y 10108

QUAD-YEAR	ELEV	DESCRIPTION (INCLUDE QUAD AND YEAR IN DESCRIPTION)	BM NUMBER
WATTS (1994)	0174.637	SPK IN CB 3FT W/O BCR 35FT S & 42FT W/O C/L INT MANCHESTER AVE & DENKER AVE	Y 10109
WATTS (1994)	0121.779	RD BM TAG IN E CB 1FT N/O BCR @ NE COR COMPTON AVE & 92ND ST 58FT N & 32FT E/O C/L INT	Y 10110
WATTS (1994)	0121.200	RD BM TAG IN S CB 3FT E/O BCR @ SE COR COMPTON AVE & 92ND ST 50FT E & 32FT S/O C/L INT	Y 10111
WATTS (1994)	0097.585	L&SPK IN CB 5FT S/O BCR @ SE COR IMPERIAL HWY & CENTRAL AVE 71FT S & 40FT E/O C/L INT	Y 10112
WATTS (1994)	0158.095	RD BM TAG IN N END OF C B 3FT S/O BCR @ SE COR BROADWAY (TO THE S) & 120TH ST 55FT S & 52FT E/O C/L INT	Y 10113
WATTS (1994)	0158.325	RD BM TAG IN N CB 7FT W/O BCR @ NW COR BROADWAY (TO THE N) & 120TH ST 45FT W & 28FT N/O C/L INT	Y 10114
BASELINE (1990)	0113.587	RD BM TAG IN CB 2FT N/O BCR @ NE COR ALAMEDA ST (W BARREL) & TWEEDY BLVD 58FT N & 29FT E/O C/L INT	Y 10141
BASELINE (1990)	0124.516	L&T IN CB 5FT N/O BCR @ SE COR FIRESTONE BLVD & ALAMEDA ST 60FT S & 29FT E/O C/L INT	Y 10142
BASELINE (1990)	0139.586	RD BM TAG IN CB 2FT S/O BCR @ SW COR ALAMEDA ST & NADEAU ST 60FT S & 35FT W/O C/L INT	Y 10143
BASELINE (1990)	0165.975	L&T IN CB 6FT N/O BCR @ SE COR ALAMEDA ST (E BARREL) & GAGE AVE 40FT S & 25FT E/O C/L INT MKD (BM)	Y 10144
BASELINE (1990)	0175.271	RD BM TAG IN CB 6FT S/O BCR @ SE COR ALAMEDA ST (E BBL) & RANDOLPH ST 50FT S & 20FT E/O C/L INT	Y 10145
WATTS (1994)	0128.780	L&CE TAG IN CB C/L PROD ZAMORA AVE FROM NORTH 37FT S/O C/L FIRESTONE BLVD & 5FT E/O BCR @ SE COR PLEVKA AVE	Y 10148
WATTS (1994)	0131.134	L&SPK IN SW COR C B 10FT N/O BCR @ NW COR MAN- CHESTER AVE & SAN PEDRO ST 70FT N & 30FT W/O C/L INT	Y 10149
WATTS (1994)	0130.527	RD BM TAG IN CB 1FT W/O BCR @ NW COR MANCHESTER AVE & BROADWAY 35FT N & 64FT W/O C/L INT	Y 10150
WATTS (1994)	0213.304	L&SPK IN CB 5FT N/O BCR @ NE COR MANCHESTER AVE & VAN NESS AVE 55FT N & 30FT E/O C/L INT	Y 10151

QUAD-YEAR	ELEV	DESCRIPTION (INCLUDE QUAD AND YEAR IN DESCRIPTION)	BM NUMBER
BASELINE (1990)	0071.272	RDBM TAG IN N CB 2FT W/O BCR @ NW COR ROSECRANS AVE & OLEANDER AVE 38FT N & 35FT W/O C/L INT	Y 10160
BASELINE (1990)	0072.412	RD BM TAG IN NW COR C B 6FT W/O BCR @ NW COR ROSECRANS AVE & ARANBE AVE 42FT N & 35FT W/O C/L INT	Y 10161
BASELINE (1990)	0095.977	RD BM TAG IN NW COR C B 9FT W/O BCR @ NW COR ROSECRANS AVE & PARMELEE AVE 60FT W & 44FT N/O C/L INT	Y 10162
BASELINE (1990)	0113.433	RD BM TAG IN S CB 17FT E/O BCR @ SE COR ROSECRANS AVE & STANFORD AVE 71FT E & 40FT S/O C/L INT	Y 10163
BASELINE (1990)	0049.054	RD BM TAG IN CB 1FT S/O BCR @ NW COR CRENSHAW BLVD & EL SEGUNDO BLVD 70FT N & 42FT W/O C/L INT	Y 10185
BASELINE (1990)	0052.752	RD BM TAG IN CB 1FT S/O BCR @ NW COR CRENSHAW BLVD & NORTHROP AVE 63FT N & 42FT W/O C/L INT	Y 10186
BASELINE (1990)	0078.439	L&BRAD IN CB 18FT S/O BCR @ NE COR CRENSHAW BLVD & IMPERIAL HWY 56FT N & 44FT E/O C/L INT	Y 10187
BASELINE (1990)	0194.666	RD BM TAG IN CB 1FT N/O BCR @ NE COR CRENSHAW BLVD & HARDY ST 42FT E & 40FT N/O C/L INT	Y 10188
BASELINE (1990)	0206.028	RD BM TAG IN CB 1FT S/O BCR @ SE COR CRENSHAW BLVD & ARBOR VITAE ST 42FT E & 32FT S/O C/L INT	Y 10189
BASELINE (1990)	0214.146	CITY OF INGLEWOOD TAG IN CB RET 17FT E/O BCR @ SW COR CRENSHAW BLVD & 90TH ST (TO THE WEST) 81FT W & 35FT S/O C/L INT	Y 10190
WATTS (1994)	0126.373	DPW BM TAG IN S CB 5FT E/O BCR @ SE COR 88TH ST & COMPTON AVE 60FT E & 19FT S/O C/L INT	Y 10558
WATTS (1994)	0131.656	DPW BM TAG IN S CB 5FT W/O BCR @ SW COR MAIN ST & MANCHESTER AVE 49FT W & 35FT S/O C/L INT	Y 10559
WATTS (1994)	0200.895	DPW BM TAG IN E CB 3FT N/O BCR @ NE COR IMPERIAL HWY & NORMANDIE AVE 67FT N & 30FT E/O C/L INT	Y 10560
WATTS (1994)	0091.158	DPW BM TAG IN N CB 1FT W/O BCR @ NW COR IMPERIAL HWY & WILMINGTON AVE 40FT N & 49FT W/O C/L INT	Y 10561
WATTS (1994)	0091.130	DPW BM TAG IN N CB 1FT E/O BCR @ NE COR IMPERIAL HWY & WILMINGTON AVE 40FT N & 46FT E/O C/L INT	Y 10562

JAD-YEAR	ELEV	DESCRIPTION (INCLUDE QUAD AND YEAR IN DESCRIPTION)	BM NUMBER
BASELINE (1990)	0093.288	DPW BM TAG IN W CB 5FT N/O BCR @ NW COR ALAMEDA ST (W BBL) & IMPERIAL HWY 95FT N & 50FT N/O C/L INT	Y 10563
BASELINE (1990)	0095.023	DPW BM TAG IN E CB 5FT N/O BCR @ NE COR ALAMEDA ST & (W BBL) & IMPERIAL HWY 85FT N & 29FT E/O C/L INT	Y 10564
WATTS (1994)	0172.938	CAL TRANS BR CAP IN E CONC WALK OF OVER-PASS 133FT S & 34FT E/O C/L INT NORMANDIE AVE & (105 FRWY) 4FT E/O E CB	Y 10565
WATTS (1994)	0158.704	DPW BM TAG IN W CB 20FT S/O BCR @ SW COR 92ND ST & BUDLONG AVE 55FT S & 20FT W/O C/L INT	Y 10566
WATTS (1994)	0152.918	DPW BM TAG IN E CB 2FT N/O BCR @ NE COR 89TH ST & BUDLONG AVE 38FT N & 20FT E/O C/L INT	Y 10567